

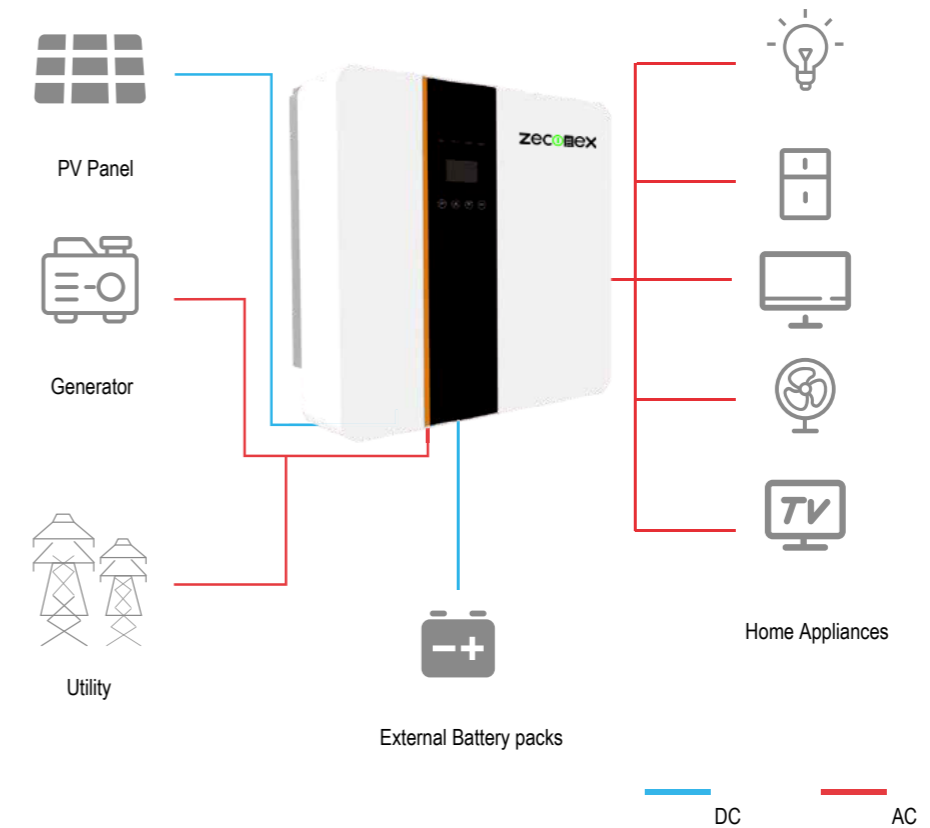

# zeconex

EXPERTS IN PV ENERGY STORAGE  
MANAGEMENT AND CONTROL



- Household photovoltaic power supply system
- All-in-one solar charge inverter system

## ZECONEX LTD

+ 86-755-84615006

sales@zeconex.com

www.zeconex.com

Building A, Hankun Hi-tech Industrial Zone, Longteng Road,  
Pingdi, Longgang District, Shenzhen, China



# Three-phase Hybrid Inverter



Villa



Residential electricity



Nomadic farm



Base station



## Product Features

### PV & Storage System

- Integrated PV and energy storage, support for a variety of batteries, integrated EMS Smart energy management system

### Friendly & flexible

- Supporting multiple parallel connections, power and capacity can be expanded
- Wide PV input voltage range 180V to 850V
- Support diesel generator access

### Safe & Reliable

- IP65 protection, all-aluminum design, built-in lightning protection, high precision leakage protection
- Passed CE, IEC and grid connection test certification in Europe, South Africa, Germany and other countries

### Smart & Simple

- Support intelligent EMS management function;
- Support on/off-grid automatic switching function to ensure uninterrupted power when important loads are off-grid

## ZECONEX LTD

+ 86-755-84615006

sales@zeconex.com

www.zeconex.com

Building ABC, Hankun Hi-tech Industrial Zone, Longteng Road, Pingdi, Longgang District, Shenzhen, China

## Residential Hybrid Solar Inverter

ZECONEX

Model	R8KH3	R10KH3	R12KH3	R15KH3
<b>Input (PV)</b>				
Max. input power(KW)	12KW	15KW	18KW	22.5KW
Max. DC voltage (V)	1000V			
MPPT voltage range(V)	180V-850V			
Max.input current of single MPPT(A)	13A			
MPPT tracker/strings	2/1		2/2	
<b>AC output</b>				
Rated output power(KVA)	8KVA	10KVA	12KVA	15KVA
Max. output current(A)	12.7A	15.9A	19.1A	23.8A
Ac output voltage(V)	400V /360V~440V			
Frequency(HZ)	50 /60HZ			
PF	0.8lagging-0.8leading			
THDI	<3%			
AC output topology	3W+N+PE			
<b>Battery</b>				
Battery voltage range(V)	125V-600V			
Max. charging voltage(V)	600V			
Full battery voltage(V)	210V	270V	300V	375V
Rated charge/discharge current(A)	50A			
Battery type	Lithium /Lead-acid			
Communication interface	CAN/RS485			
<b>EPS Output</b>				
Max. output power (KVA)	8.8KVA	11KVA	13.2KVA	16.5KVA
Rated output voltage(V)	400Vac			
Max. output current(A)	12.7A	15.9A	19.1A	23.8A
Rated frequency (HZ)	50Hz /60Hz			
Automatic switching time (MS)	<20ms			
THDU	<2%			
Overload capacity	110%, 30S/120%, 10S/150%, 0.02S			
<b>General Data</b>				
Battery Charge/Discharge	97.5%	97.5%	97.6%	97.8%
DC Max. Efficiency	97.9%	98.2%	98.2%	98.5%
Euro Efficiency	97.2%	97.5%	97.5%	97.6%
MPPT Efficiency	99.9%	99.9%	99.9%	99.9%
Protection class	IP65			
Noise Emission (Typical)	35dB			
Operation Temperature	-25~+60°C			
Cooling	Natural			
Operation Temperature	-35°C ~ 60°C			
Relative Humidity	0 ~100% (non-condensing)			
Altitude	2000m(>2,000 Derating)			
Dimensions (W/D/H) MM	530*220*560mm			
Weight(KG)	30KG	30KG	31KG	32KG
Isolation transformer	No			
Self-Consumption	<3W			
<b>General Data</b>				
Display	LCD/APP			
InterfaceRS485/WIFI/LAN/CAN/DRM	yes /opt/opt/yes/yes			
Safety standard	IEC/EN62109-1/-2, IEC/EN62477-1			
EMC	IEC/EN 61000-6-1, IEC/EN 61000-6-3			
On-grid	Europe: EN50549-1, Germany: VDE4105/0124, UK: G99, South Africa: NRS097-2-1:2017			

# Single-phase Hybrid Inverter



Villa



Residential electricity



Nomadic farm



Base station



## Product Features

### PV & Storage System

- Integrated PV and energy storage, support for a variety of batteries, integrated EMS Smart energy management system
- Wide PV input voltage range 125V to 500V

### Friendly & flexible

- Supporting multiple parallel connections, power and capacity can be expanded
- Support on/off-grid automatic switching function to ensure uninterrupted power when important loads are off-grid

### Safe & Reliable

- IP65 protection, all-aluminum design, built-in lightning protection, high precision leakage protection
- Passed CE, IEC and grid connection test certification in Europe, South Africa, Germany and other countries

### Smart & Simple

- Support intelligent EMS management function
- Support flexible access of diesel generator

## ZECONEX LTD

+ 86-755-84615006

sales@zeconex.com

www.zeconex.com

Building ABC, Hankun Hi-tech Industrial Zone, Longteng Road, Pingdi, Longgang District, Shenzhen, China

## Residential Hybrid Solar Inverter

ZECONEX

model	R3KL1	R3K6L1	R4KL1	R4K6L1	R5KL1	R6KL1
<b>Input (PV)</b>						
Max. input power(KW)	4.6KW		6KW		7KW	
Max. DC voltage(V)	550V					
MPPT voltage range(V)	125~550V					
Max. input current of single MPPT(A)	14A					
MPPT tracker/strings	2/1					
<b>AC output</b>						
Rated output power(KVA)	3KVA	3.68KVA	4KVA	4.6KVA	5KVA	6KVA
Max. output current(A)	13A	16A	17.4A	20A	21A	26A
Grid voltage/range(V)	230/176~270V					
Frequency (HZ)	50 /60					
PF	0.8lagging-0.8leading					
THDI	<3%					
AC output topology	L+N+PE					
<b>Battery</b>						
Battery voltage range(V)	40~58V					
Max. charging voltage(V)	58V					
Max. charge/discharge current(A)	95A/62.2A	95A/75A	95A/83.3A	95A/95.8A	95A/104.2A	95A/110A
Battery type	Lithium /Lead-acid					
Communication interface	CAN/RS485					
<b>EPS output</b>						
Rated power (KVA)	3KVA	3.68KVA	4KVA	4.6KVA	5KVA	6KVA
Rated output voltage(V)	230Vac					
Rated output current(A)	13A	16A	17.4A	20A	21.7A	26A
Rated frequency (HZ)	50 /60Hz					
Automatic switching time (MS)	<20ms					
THDU	<2%					
Overload capacity	110%, 30S/120%, 10S/150%, 0.02S					
<b>General data</b>						
Battery charge/discharge efficiency	95%					
DC Max. efficiency	97.6%					
Europe efficiency	97.7%					
MPPT efficiency	99.9%					
Ingress protection	IP65					
Noise emission (DB)	<35DB					
Operation temperature	-25~+60°C					
Cooling	Natural					
Relative humidity	0 ~95% (non-condensing)					
Altitude	2,000m(>2,000 Derating)					
Dimensions W*D*H (MM)	550/200/515mm					
Weight (KG)	25KG					
Self-consumption(W)	<3W					
<b>Display and communication</b>						
Display	LCD					
Interface:RS485/WiFi/4G/CAN/DRM	Yes/ Opt/ Opt/ Yes/ Yes					
Safety standard	IEC/EN62109-1/-2, IEC/EN62477-1					
EMC	IEC/EN 61000-6-1, IEC/EN 61000-6-3					
On-grid	South Africa NRS097-2-1:2017, UK G98,G99					